

**Granberg Chainsaw Accessories**  
 259-261 Ferntree Gully Road  
 Mount Waverley Victoria 3149  
 Australia  
 www.granberg.com.au

**G-776**  
**ALASKAN MKIII**  
**ASSEMBLY INSTRUCTIONS**  
**AND PARTS LIST**

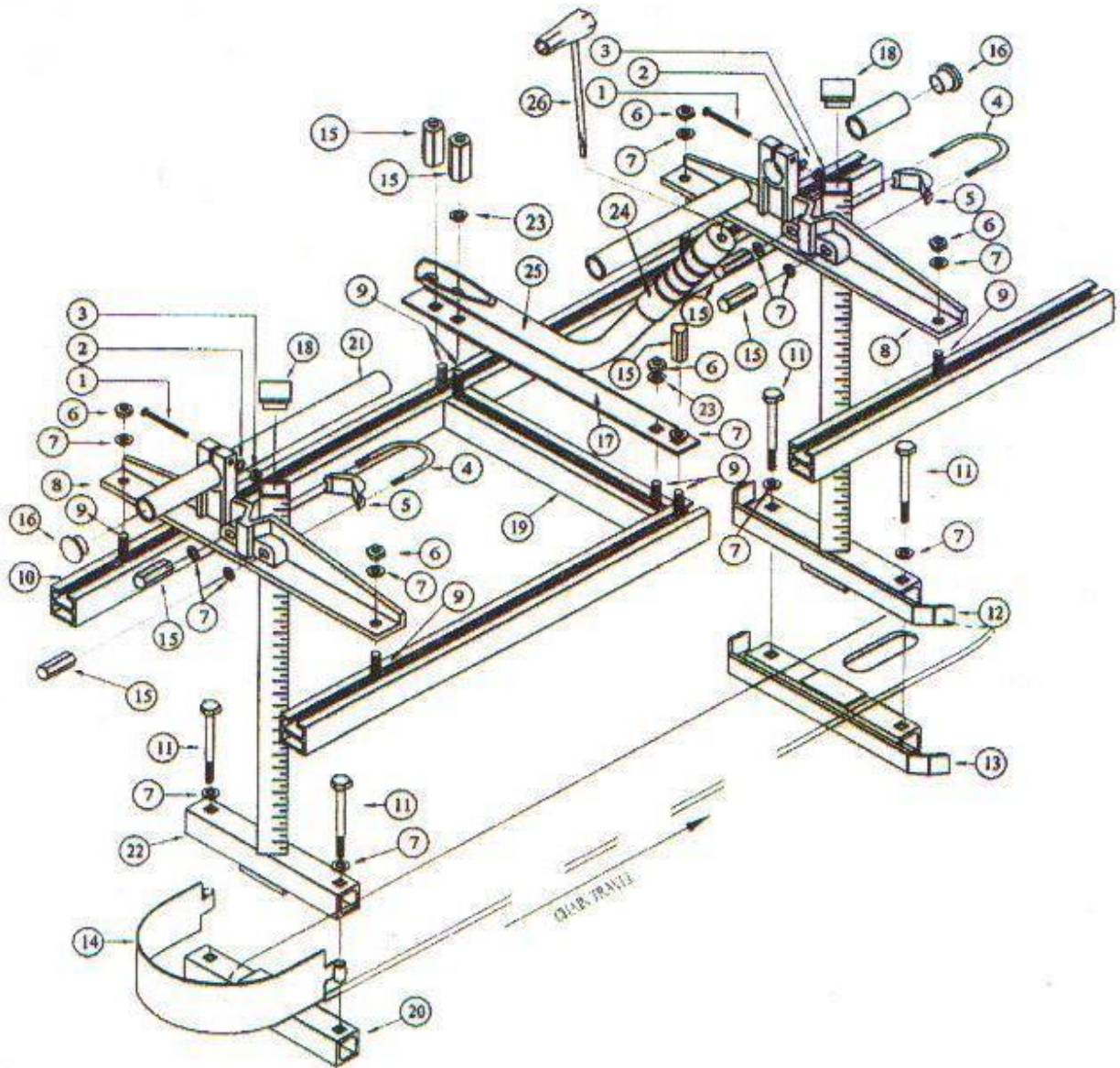

ITEM NO.	PART NO.	QTY.	DESCRIPTION
1.	809	4	PAN HD. SCREW M5x40
2.	323	4	FLAT WASHER M5
3.	935	4	NYLOC NUT M5
4.	1794	2	U-CLAMP M8
5.	804	2	POST CLAMP
6.	684	6	NYLOC NUT M8
7.	871	15	FLAT WASHER M8
8.	782	2	END BRACKET
9.	806	8	CRG BOLT M8x20
10.	781-2	2	THICKNESS RAIL G-776-24
	781-3	2	THICKNESS RAIL G-776-30
	781-4	2	THICKNESS RAIL G-776-36
	781-5	2	THICKNESS RAIL G-776-48
	781-6	2	THICKNESS RAIL G-776-56
11.	779	4	HEX BOLT M8x90
12.	791	1	ADJ. POST/THRUST END
13.	790	1	CLMP. BRKT./THRUST END

ITEM NO.	PART NO.	QTY.	DESCRIPTION
14.	795	1	NOSE GUARD
15.	702	7	COUPLING NUT M8
16.	785	2	END CAP/HANDLE
17.	784	1	TIE BAR
18.	778	2	END CAP/RISER POST
19.	799	1	ON-OFF GUIDE BAR
20.	708	1	CLMP. BRKT./NOSE END
21.	793-1	1	HANDLE G-776-24
	793-2	1	HANDLE G-776-30
	793-3	1	HANDLE G-776-36
	793-4	1	HANDLE G-776-48
	793-5	1	HANDLE G-776-56
22.	792	1	ADJ. POST/NOSE END
23.	685	2	DELETED
24.	874	1	GRIP
25.	596	1	HANDLE
26.	703	1	WRENCH